

OK

THE CITY OF NAPOLEON

BUILDING & ZONING DEPARTMENT

255 W. RIVERVIEW

(419)592-4010

Building Permit

Permit Number: BP2007-102

Page 1 of 1

Printed: 6/18/2007

ADDRESS:

116 Meekison St.

Applicant

Name: Terry Branham
Address:

Approval Date:

Owners

Name: Mr. John Jacoby
Address: 116 Meekison St
Napoleon, OH 43545

Phone: 419-599-1239

Contractors

Fees and Receipts:

Number	Description	Amount
FEE2007-340	Building Permit Fee (Auto)	\$12.00
FEE2007-342	State 1% fee (Calc)	\$0.12
Total Fees:		\$12.12
RCPT2007-295		\$12.12
Total Receipts:		\$12.12

front porch

APPLICANTS SIGNATURE: _____ DATE: _____

REMINDER: YOU MUST CALL (419)592-4010 FOR AN INSPECTION

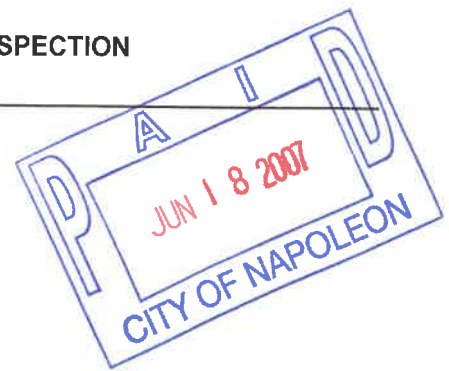

CITY OF NAPOLEON GENERAL PERMIT APPLICATION

THIS APPLICATION IS FOR RESIDENTAL CONSTRUCTION INCLUDING BUILDING, ELECTRICAL, PLUMBING, MECHANICAL, DEMOLITIONS, REMODELING.

DATE: 5-10-07 JOB LOCATION: 116 MEEKISON

OWNER: JOHN JOCOBY PHONE: 419-599-1239

OWNER ADDRESS: 116 MEEKISON CITY: NA ZIP: 43545

CONTRACTOR: ~~CHRIS GAZZ~~ Terry Boord Branham

PHONE #: 419-599-1239 CELL PHONE# _____

CONTRACTOR LICENSED WITH THE CITY OF NAPOLEON

Is any of the above job going to be subcontracted out? Y

If yes to whom: _____

*Between 9 & 10 Am
Thursday
Needs 25' setback
MAP shows now approx 20'*

DESCRIPTION OF WORK TO BE PERFORMED: ADD

ESTIMATED COMPLETION DATE: _____

PLEASE MARK THE TYPE OF WORK YOU WILL BE PERFORMING

- | | |
|---|--|
| <input type="checkbox"/> A/C ADD ON | <input type="checkbox"/> REMODELING |
| <input type="checkbox"/> BOILER REPLACEMENT | <input type="checkbox"/> ROOFING |
| <input type="checkbox"/> CURBING | <input type="checkbox"/> SEWER REPAIRS** |
| <input checked="" type="checkbox"/> DECKS * | <input type="checkbox"/> SIDEWALK* |
| <input type="checkbox"/> DRIVEWAY* | <input type="checkbox"/> SIDING |
| <input type="checkbox"/> ELECTRICAL SERVICE UPGRADE | <input type="checkbox"/> STORAGE SHED* |
| <input type="checkbox"/> ELECTRICAL SERVICE NEW | |
| <input type="checkbox"/> FENCE* | |
| <input type="checkbox"/> ADDITIONS* | |
| <input type="checkbox"/> FURNACE NEW | |
| <input type="checkbox"/> LAWN METER | |
| <input type="checkbox"/> PLUMBING | |

*Called 5-2-07
Told them to get with me
about how big & how high the
deck is to be
18" high
out 48" width 50" x 65"*

*PLEASE INCLUDE A PICTURE SKETCH OF THE PROJECT AND PROPERTY LINES. INDICATING

** IF WORK REQUIRES GOING INTO ADJACENT PROPERTY

FOR PERMIT COSTS

PERMIT COST WORKSHEET

JOB	BASE FEE	TOTAL
SIDING (only) TOTAL SQ _____ X 1.00 +	\$5.00 =	\$ _____
ROOFING (only) TOTAL SQ _____ X 1.00 +	\$5.00 =	\$ _____
WINDOWS / DOORS(only) # ___ X 1.00 +	\$5.00 =	\$ _____
ELECTRICAL # OF CIRCUITS _____ X 3.00 +	\$15.00 =	\$ _____
ELECTRICAL SERVICE UPGRADE	\$15.00 =	\$ _____
PLUMBING (INSIDE) replacing/ repairs	\$10.00 =	\$ _____
SEWER (OUTSIDE)	\$25.00 =	\$ _____
WATER HEATER	\$5.00	\$ _____
SHED UNDER 200 SQ FT (over 200 see chart)	\$ 5.00	\$ _____
FURNACE OR A/C (REPLACEMNT)	\$ 5.00	\$ _____
DEMOLITION (only)	\$30.00	\$ _____
SIDEWALK REPLACEMENT/ NEW	\$25.00	\$ _____
DRIVEWAY	\$25.00	\$ _____

ALL CONSTRUCTION, ALTERATIONS, REMODELING, SHEDS, DECKS & FENCES NOT LISTED ABOVE IS BASED ON COST OF WORK BEING PERFORMED.

COST OF WORK \$ 1200 (SEE CHART) \$ 10⁰⁰

0.00	-	250.00	0.00	11,000.00	-	11,999.00	25.00
250.00	-	1,000.00	10.00	12,000.00	-	12,999.00	26.00
1,000.00	-	1,999.00	12.00	13,000.00	-	13,999.00	27.00
2,000.00	-	2,999.00	14.00	14,000.00	-	14,999.00	28.00
3,000.00	-	3,999.00	16.00	15,000.00	-	15,999.00	29.00
4,000.00	-	4,999.00	18.00	16,000.00	-	16,999.00	30.00
5,000.00	-	5,999.00	19.00	17,000.00	-	17,999.00	31.00
6,000.00	-	6,999.00	20.00	18,000.00	-	18,999.00	32.00
7,000.00	-	7,999.00	21.00	19,000.00	-	19,999.00	33.00
8,000.00	-	8,999.00	22.00	20,000.00	-	20,999.00	34.00
9,000.00	-	9,999.00	23.00	21,000.00	-	21,999.00	35.00
10,000.00	-	10,999.00	24.00	22,000.00	-	22,999.00	36.00
				Over 22,999	Please Call		

*OTHER FEES NOT LISTED MAY APPLY

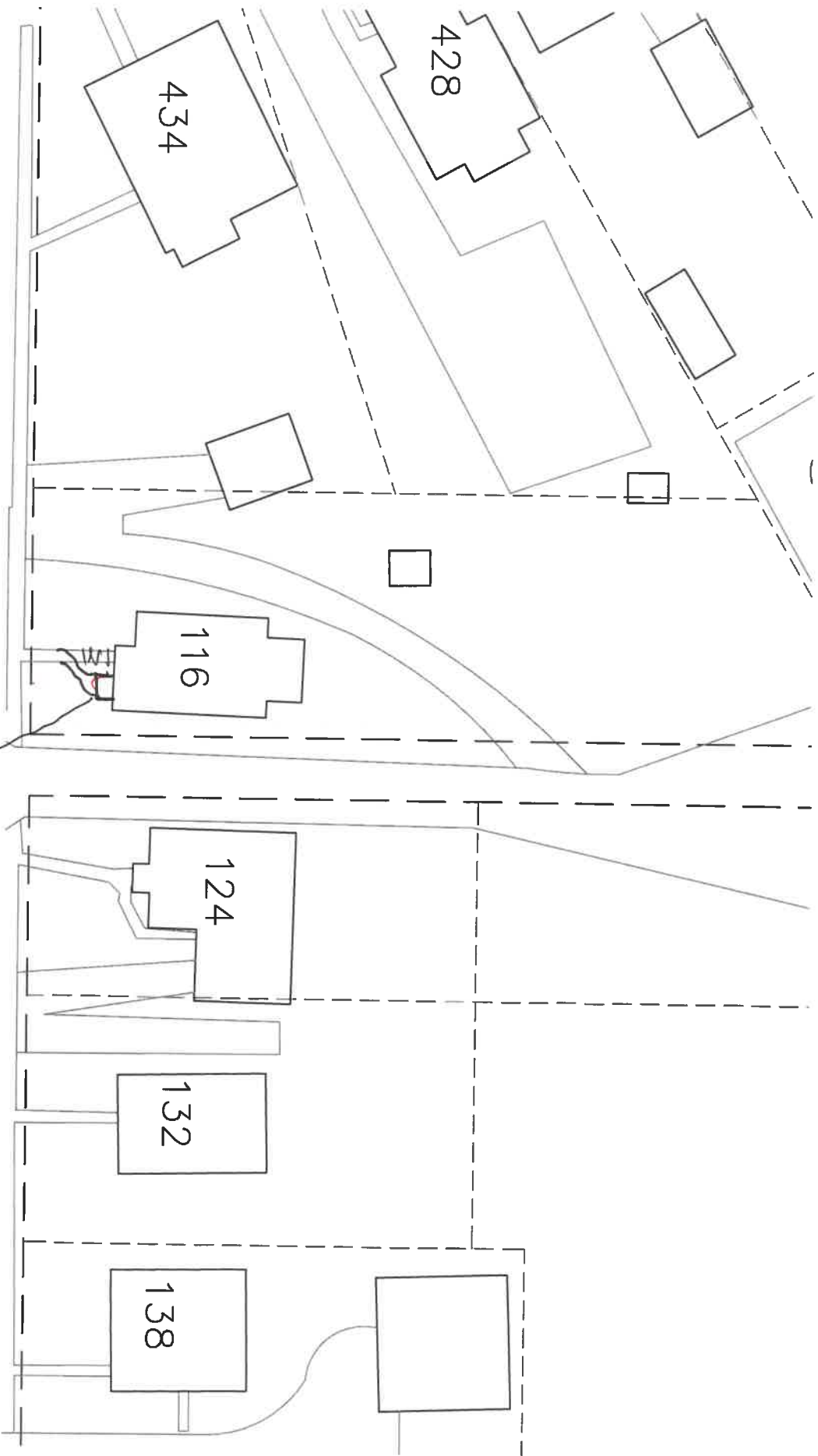

out 4' - 3 1/2'

4' deck less than 18" with handover

